

Checklist

Built-In-, Signal-Lights and Indicator Series Ø63



Please fill out the checklist as completely as possible and send the PDF document to: info@tsl-escha.com
After checking the conformity of the checklist, you will receive a final article drawing in which the product is clearly described. In addition, you will receive an attractive offer according to your specifications. We will also be happy to complete the checklist together with you. Please call us if required: +49 2353/66796-0

In this series, flexibility was emphasized. The device selection consists of luminaires, signal lights, or indicator lights. Additionally, different glass bodies can be used on the front to increase visibility from various angles. Upon request, the products can be implemented with an acoustic signal.

CUSTOMER INFORMATION

Company:

Name:

Address:

Phone:

E-Mail:

Date:

Project:

Quantity:

Quantity 1. year:

Quantity 2. year:

Quantity 3. year:

Notes:

1 DEVICE SELECTION

EL/SLF Light/Signal light with flat glass

SLF Signal light with flat glass and bicolor field

ML indicator light with flat backlighted glass

SL Signal light with curved glass, glass height ~3 mm

ELE/SLE Light/Signal light with raised glass, glass height ~11 mm

ELK/SLK Light/Signal light with domed glass cover, glass height ~22 mm

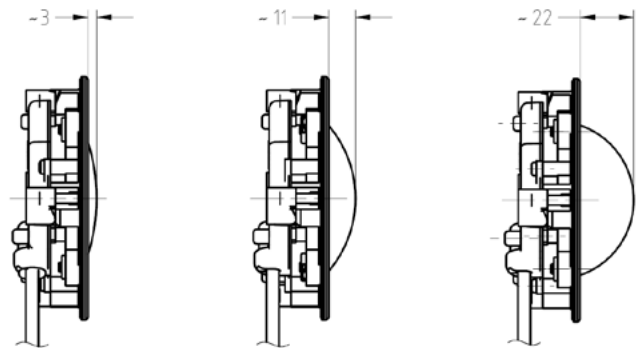
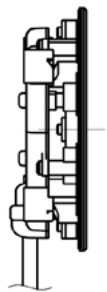

2 MOUNTING/CONSTRUCTION TYPE

Construction Type 3

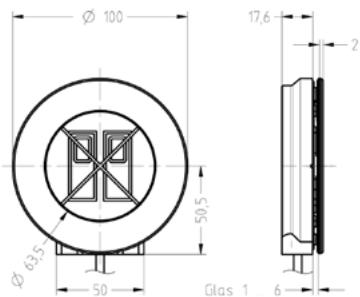

ML63-3

Maße ohne Toleranz in mm
Dimensions without tolerance in mm



Construction Type 5

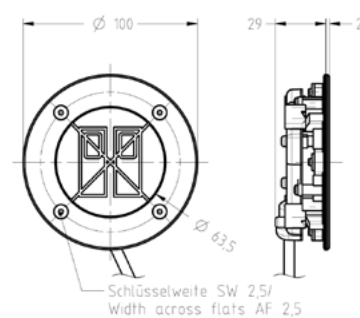
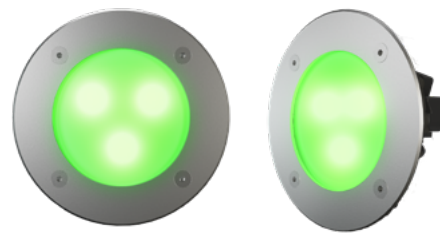

ML63-5

Maße ohne Toleranz in mm
Dimensions without tolerance in mm



3 CABLE OUTLET

Bottom

Left

Right

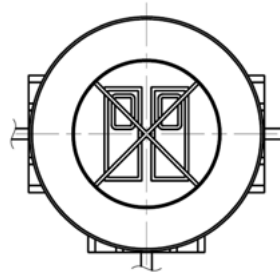

4 VARIABLE ADAPTATION TO THE DOOR PROFILE (When selecting the Construction Type 3)

Angle 0 °











Angle 6 °

Angle 10 °

Angle 25°

5 FRONT PANEL

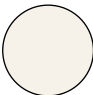
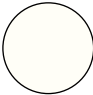
The front panels are available in powder-coated stainless steel

 RAL 1021	 RAL 1023	 RAL 2008	 RAL 3000	 RAL 3020	 RAL 6024	 RAL 7035
 RAL 7042	 RAL 7043	 RAL 9010	 RAL 9016	 RAL 9017		



Stainless steel
matt not powder
coated

RAL-color or color shade on request

6 SELECTION OF LED LIGHTING, GLASS COLORING, SIGNAL RANGE AND INDICATOR RANGE.

SL Signal light

LED-COLOR

GLASSCOLOR

ELE/SLE Light/Signal light

LED-COLOR

GLASSCOLOR

EL Light

LED-COLOR

GLASSCOLOR

ELK/SLK Light/Signal light

LED-COLOR

GLASSCOLOR

SLF Signal light



LED1 inner circle + LED2 outer ring
red and white

LED-Color on request

ML Indicator light

LED-COLOR

PICTOGRAM FOR INDICATOR LIGHT

B08		B09		B11		B12		B13		B21	
B22		G23		B25							

7 NOMINAL VOLTAGE

24 VDC

110 VDC

VDC

8 CONNECTION CABLES

64) TE Mini-Universal MATE-N-LOK, TE 794805-1 4pole (IP56/IP57)

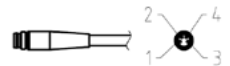
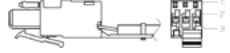

60) ESCHA M8/Ø8 Snap (max. 60 VDC) SSFP4 4pole (IP68)

26) WAGO 721
721-603/000-044/032-000 3pole20) WAGO 769
769-103 3pole40) WAGO 721
721-602/000-044/032-000 2pole84) WAGO 769
769-102 2pole

63) TE Mini-Universal MATE-N-LOK 794894-1 2pole (IP56)

8S) TE ULTRAFAST 250
2-520184-2, 6,3 x 0,8 mm

8A) With wire-end sleeve



Customer specific

9 CONNECTION LINE

(ACCORDING TO EN 45545-2 AND UN/ECE R118)

L = ca. 130 mm

L = mm (Minium length 120mm)

PIN ASSIGNMENT

PIN	Unicolored	Bicolored
PIN 1	+UB	+UB LED1
PIN 2	GND	GND
PIN 3	-	+UB LED2
PIN 4	-	-