



## Magnetic sensor 126

### Product characteristics

- Magnetic sensor on reed-contact basis
- Small housing for space-saving installation
- PA housing
- $\varnothing 6$  x 30 mm
- PVC cable

### Technical drawing

IMAGE 1/2

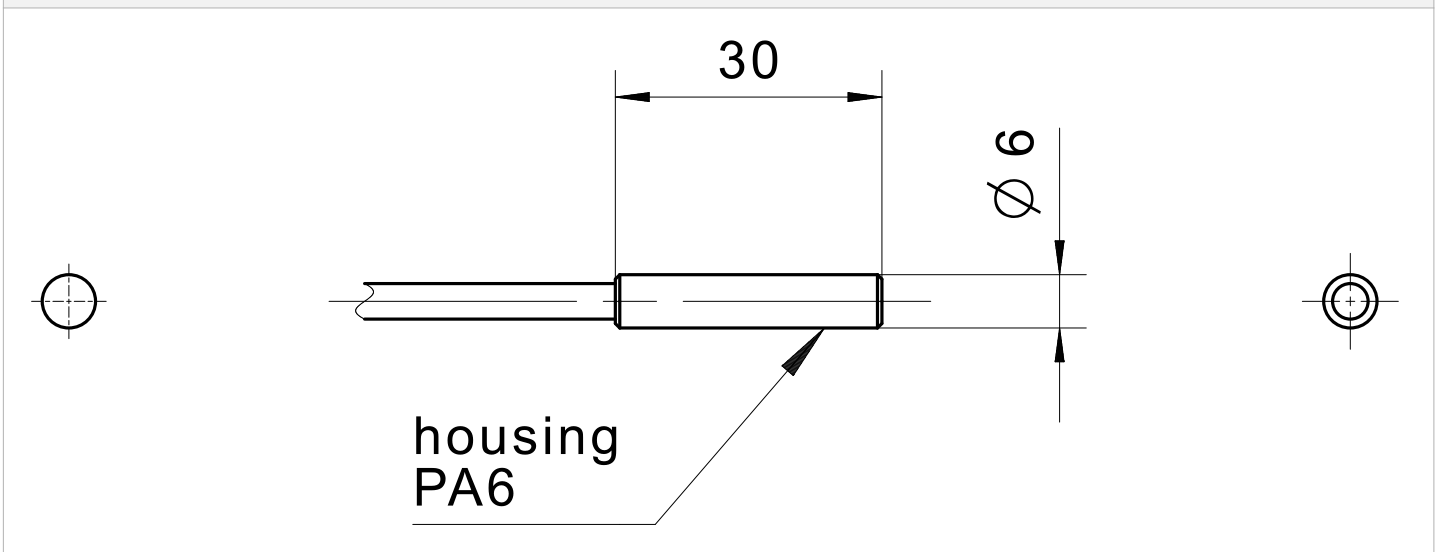
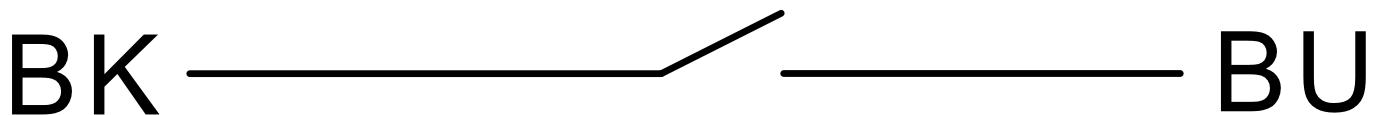
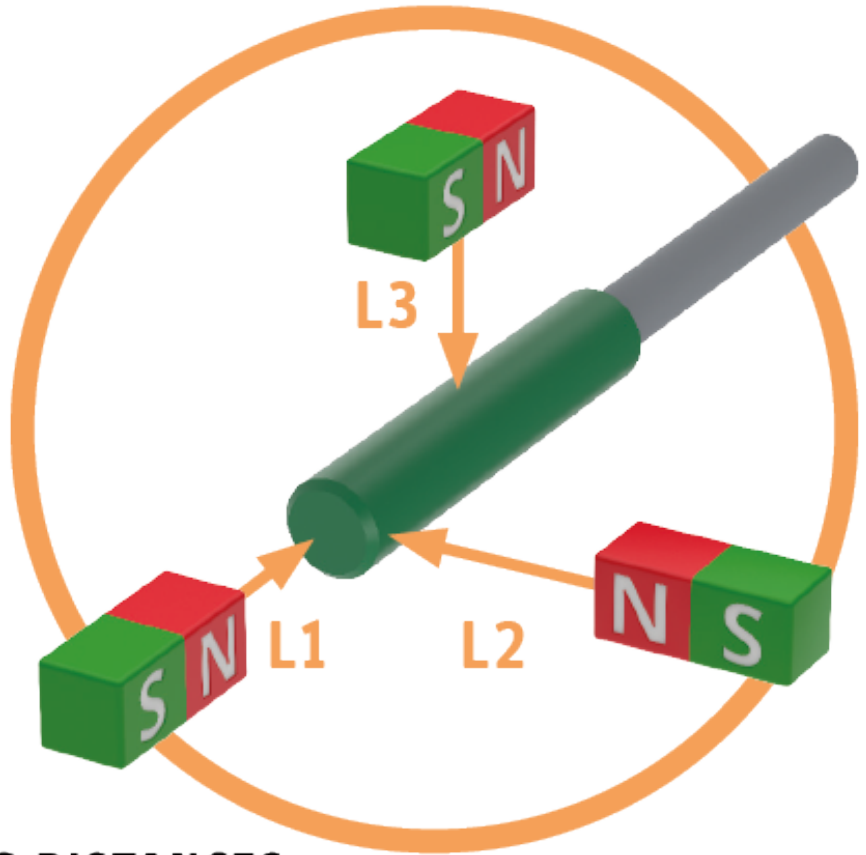

IMAGE 2/2



**Product options**

IMAGE 1/2



**TYPICAL SWITCHING DISTANCES**

	126210		
<b>ACTUATORS</b>	<b>L1</b>	<b>L2</b>	<b>L3</b>
324790	17 mm	13 mm	11 mm
300790	21 mm	17 mm	15 mm
300780	28 mm	20 mm	20 mm

Further actuators and switching distances on request

IMAGE 2/2

**ORDERING KEY**

126			<b>Magnetic sensor, reed contact</b>
	210		N.O. – cable connection 1 m
			<b>Other available cable lengths</b>
		-3	3 m
		-5	5 m
		-10	10 m
			Other cable materials and cable lengths on request

### Article characteristics

Attribute	126210
Max. switching voltage	48 V DC
Max. switching voltage	48 V AC
Max. switching current	0.5 A
Max. switching power	10 W
Technology	Reed
Contact form	NO
LED display	No
Actuation	arbitrary
Switching principle	magnetic
Dimensions	D6 L=30
Housing design	cylindrical
Housing material	PA6
Cable material	PVC
Protection class	IP67 DIN EN 60529
Operating temperature min.	-25 °C
Max. operating temperature	75 °C
Min. storage temperature	-25 °C
Max. storage temperature	75 °C
Min. cable temperature range, moving	-25 °C
Max. cable temperature range, moving	80 °C
Min. cable temperature range, fixed installation	-40 °C
Max. cable temperature range, fixed installation	80 °C
Mounting type	inserted
Cable length	1 m