

## Dimensions

Unless otherwise specified, a tolerance of  $\pm 0.4\text{mm}$  applies to all dimensions.

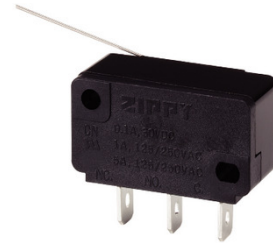

## Contact Configuration

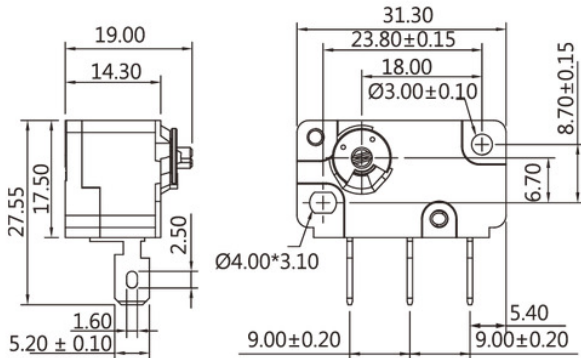
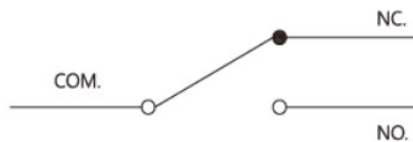

## Application

TV Game, Vending Machine, Coin-op Phone Pin-Ball Game

## Specifications

### Operating frequency(mechanical):

120 Operation / min

### Operating frequency(electrical):

10~30 Operation / min

### Insulation resistance(at 500 VDC)

100M  $\Omega$ (Min)

### Service life(mechanical)

Min. 10,000,000 Operations

### Service life(electrical)

Min. 6,000 Operations

## Rating

0.1A 125 VAC, 1A/5A 125/250VAC ; 0.1A 30VDC

## Operating Force

MODEL	Rating	L	S	H
CNR	0.1A	*	*	*
	1A	*	*	*
	5A	*	*	*

NOTE : The Symbol " \* " to represent the result is accepted

## Operating Characteristics

Type	L	S	H
Operating Force(OF)Max	5.1 gf	7.6 gf	10.2 gf
Releasing Force(RF)Min.	0.6 gf	0.9 gf	1.3 gf
Operating Position(OP)	18 $\pm$ 3°		
Releasing Position(RP)	9 $\pm$ 4°		

## Actuator Types

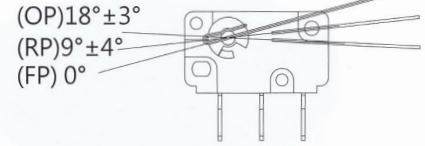
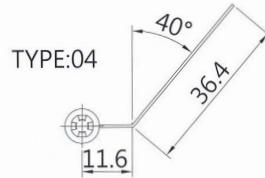
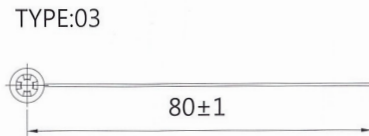
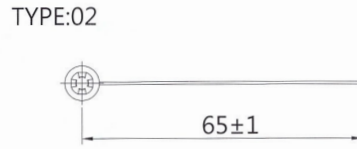
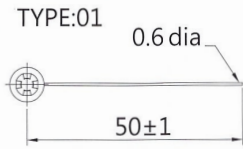

## Order Information

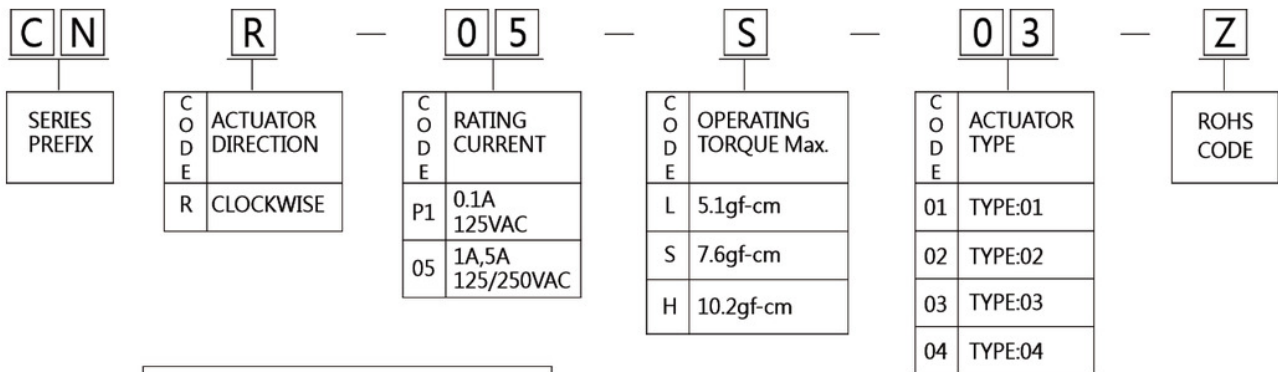

#NOTE		
ITEM	RATING CURRENT	OPERATING FORCE
1	Code:P1	L,S,H
2	Code:05	L,S,H