

# Datasheet

050FC0C

Three-pole limit switch, 3 N.O.



## Features

<b>Range</b>	Limit switches and cables
<b>components</b>	Three-pole limit switches
<b>Code</b>	050FC0C
<b>Description</b>	Three-pole limit switch, 3 N.O.
<b>Colour</b>	Giallo
<b>Weight - gr</b>	62.0
<b>Customs Tariff</b>	8536500700
<b>GTIN</b>	8052878048938

## Datasheet

<b>Approvals</b>	CE, UL, CSA
<b>Compliance with standards</b>	IEC-EN60947-1, IEC-EN60947-5-1, UL508, CSA C22-2
<b>Compliance to EMC standards</b>	EN61000-4-2, EN61000-4-3, EN61000-4-4, EN61000-4-5
<b>Compliance to EMC standards</b>	EN61000-4-6, EN61000-4-11, EN61000-6-2, EN61000-6-3
<b>Compliance to EMC standards</b>	EN50014-1, EN50082-2, EN55014, EN55022
<b>Compliance to directives</b>	2014/35/EU, 2014/30/EU, RoHS 2011/65/EU
<b>Operating temperatures</b>	-25° ÷ +65°C
<b>Protection degree</b>	IP20 (IEC-EN60529)
<b>Protection against impact</b>	IK03 (IEC-EN62262)
<b>Housing material</b>	ABS
<b>Terminal blocks</b>	Screw connection with tension sleeve
<b>Conductor cross section (terminals block 1)</b>	1x0.2 mm <sup>2</sup> (24 AWG)min. / 1x2.5mm <sup>2</sup> (12AWG) max.
<b>Conductor cross section (terminals block 2)</b>	1x0.2 mm <sup>2</sup> (24 AWG)min. / 1x4.0mm <sup>2</sup> (10AWG) max.
<b>Screw terminals tightening torque</b>	0.5 ÷ 0.6Nm (4.4÷5.5 Lb-in)
<b>Current consumption</b>	10mA
<b>Rated insulation voltage</b>	Ui 690V - Uimp 4KV (IEC-EN60947-1)
<b>Flashing safety device to detect voltage presence</b>	It reveals the lack of one or more phases
<b>Working voltage 3 phase system</b>	220÷690V 50-60Hz
<b>Working voltage single phase system</b>	110÷400V 50-60Hz
<b>Warranty period</b>	18 months

# Technical drawings

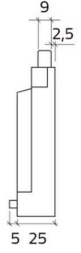
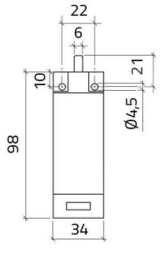

3NO

1-2  
3-4  
5-6

