

[Article Page](#)

Product Description

inductive sensor NAMUR

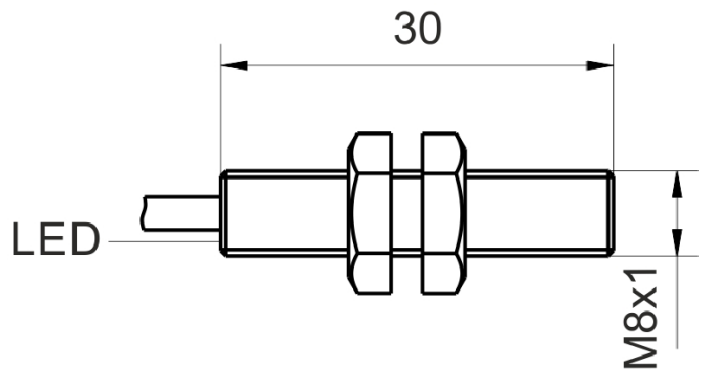
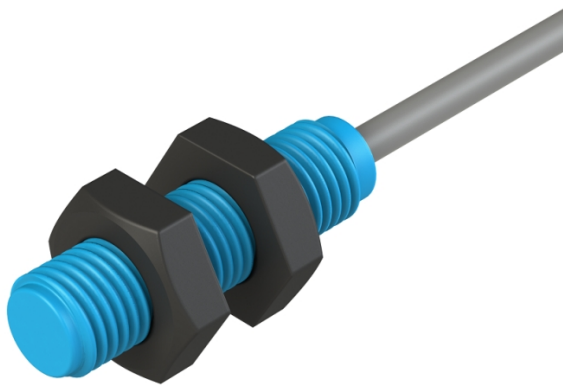

Name
Order number
Matchcode
Switching distance
Mounting

KJ2-M8KN30-NA-HT125-X0241
08317321632
9932-1632
2 mm

 non shielded
Namur

Signal Type
Connection

 Cable

Connection diagramm

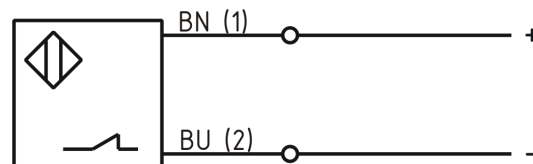

fine-pitch thread M8 x 30

Dimension (in mm)
Technical Specification
Special features
Operating voltage
Max. ripple
Switching frequency
Operating temperature
Temperature drift
Repeat accuracy
Short-circuit proof
Overload protection
Reverse voltage protection
Protection category
EMC-level
Housing material
Termination

temperature resistant up to 125°C
6 - 12 VDC
≤ 5 %
1000
-25 ° C to 125 ° C
≤ 10 %
≤ 10 %
yes
yes
yes
IP67
DIN EN 60947-5-6:2000-12
Arnite
5m PTFE 2x0,25mm²

Errors and omissions exceptet