

[Article Page](#)

Product Description

inductive sensor DC

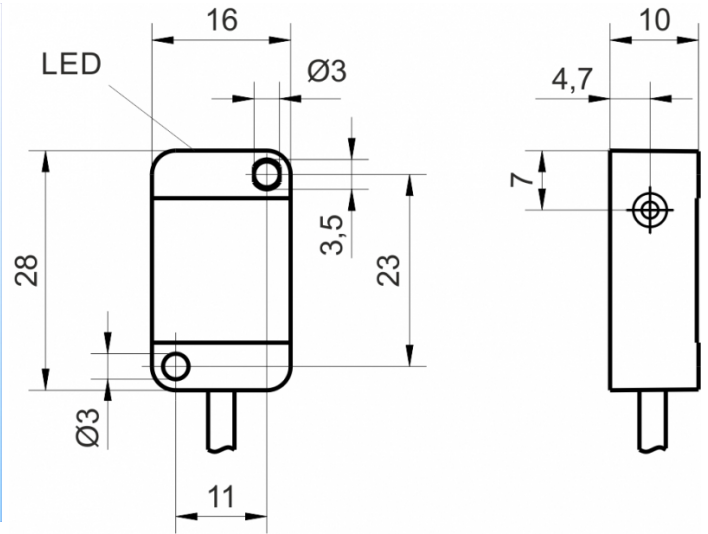

Name
Order number
Switching distance
Mounting

KJ2-Q28KB-DPÖ
08310000437
2 mm

 shielded

Switch type

 N.C.
DC PNP

Signal Type
Connection

 Cable

Connection diagramm

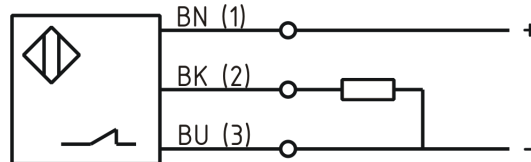

Q 28 x 10 x 16

Dimension (in mm)
Technical Specification
Operating voltage
Max. ripple
Voltage drop
Max. load current
No load current
Leakage current
Switching frequency
Switching hysteresis
Operating temperature
Temperature drift
Repeat accuracy
Switching state
Time delay
Short-circuit proof
Overload protection
Reverse voltage protection
Protection category
EMC-level
Housing material
Cable length

10 - 30 VDC
≤ 10 %
2,4 V
200 mA
≤ 13 mA
≤ 10 µA
1000 Hz
≤ 15 %
-25 ° C to 70 ° C
≤ 10 %
≤ 2 %
LED
100 ms
yes
yes
yes
IP67
DIN EN 60947-5-2: 2008
Plastic
2 m



KJ2-Q28KB-DPÖ

Pulsotronic GmbH & Co. KG Neue Schichtstraße 14b 09366 Niederdorf Deutschland +49 (0)37296 930-200

Utilisation category	DC 13
Cable material	PVC LIYY grau (grey)
Cable cross	3x0.14 mm ²
FIT / MTTF acc. to SIEMENS 29500	40,55 / 2815y
Housing Material	PA6 GF30 black translucent

Errors and omissions exceptet