

[Article Page](#)

Product Description

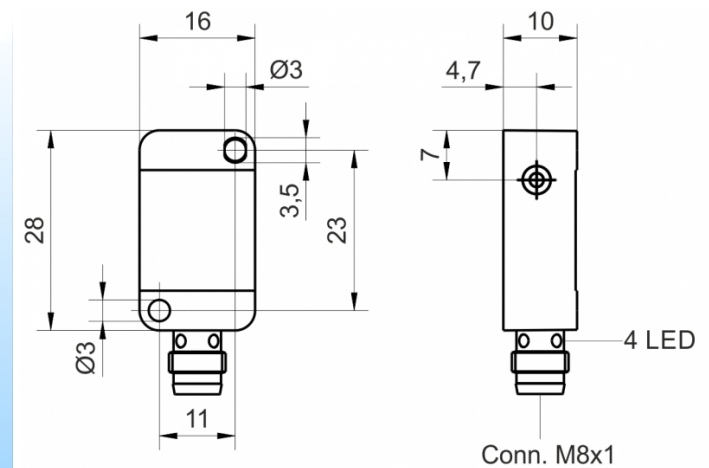

inductive sensor DC



Name
Order number
Switching distance
Mounting

Switch type

Signal Type
Connection
Connection diagramm

KJ4-Q28KN-DPÖ-V1
08310020184
4 mm

non shielded

N.C.
DC PNP
connector M8

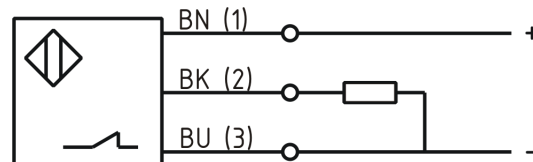

Q 28 x 10 x 16

Dimension (in mm)
Technical Specification
Operating voltage
Max. ripple
Voltage drop
Max. load current
No load current
Leakage current
Switching frequency
Switching hysteresis
Operating temperature
Temperature drift
Repeat accuracy
Switching state
Time delay
Short-circuit proof
Overload protection
Reverse voltage protection
Protection category
EMC-level
Housing material
Utilisation category
Contact material

10 - 30 VDC
≤ 10 %
2,4 V
200 mA
≤ 13 mA
≤ 10 µA
800 Hz
≤ 15 %
-25 ° C to 70 ° C
≤ 10 %
≤ 2 %
LED
100 ms
yes
yes
yes
IP67
DIN EN 60947-5-2:2008
Plastic
DC 13
Cu



KJ4-Q28KN-DPÖ-V1

Pulsotronic GmbH & Co. KG Neue Schichtstraße 14b 09366 Niederdorf Deutschland +49 (0)37296 930-200

Contact surface material

NiAu

Termination

Connector M8 3pin

FIT / MTTF acc. to SIEMENS 29500

40,55 / 2815y

Housing material

PA6 GF30 black translucent

Errors and omissions exceptet