

[Article Page](#)

Product Description

inductive sensor DC

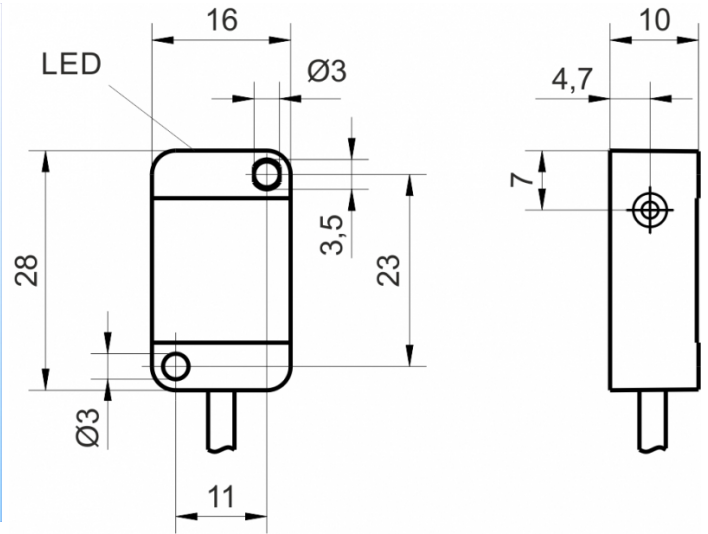

Name  
Order number  
Switching distance  
Mounting

KJ4-Q28KN-DPS  
08310000610  
4 mm

non shielded

Switch type

N.O.  
DC PNP

Signal Type  
Connection

Cable

Connection diagramm

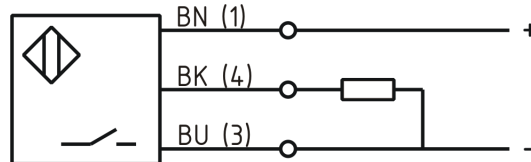

Q 28 x 10 x 16

Dimension (in mm)  
Technical Specification  
Operating voltage  
Max. ripple  
Voltage drop  
Max. load current  
No load current  
Leakage current  
Switching frequency  
Switching hysteresis  
Operating temperature  
Temperature drift  
Repeat accuracy  
Switching state  
Time delay  
Short-circuit proof  
Overload protection  
Reverse voltage protection  
Protection category  
EMC-level  
Housing material  
Cable length

10 - 30 VDC  
≤ 10 %  
2,4 V  
200 mA  
≤ 13 mA  
≤ 10 µA  
800 Hz  
≤ 15 %  
-25 ° C to 70 ° C  
≤ 10 %  
≤ 2 %  
LED  
100 ms  
yes  
yes  
yes  
IP67  
DIN EN 60947-5-2: 2008  
Plastic  
2 m



## KJ4-Q28KN-DPS

Pulsotronic GmbH & Co. KG Neue Schichtstraße 14b 09366 Niederdorf Deutschland +49 (0)37296 930-200

Utilisation category	DC13
Cable material	PVC LIYY grau (grey)
Cable cross	3x0.14 mm <sup>2</sup>
FIT / MTTF acc. to SIEMENS 29500	39,89 / 2862y
Housing material	PA6 GF30 black translucent

**Errors and omissions exceptet**