

[Article Page](#)

Product Description

inductive sensor pressure resistant

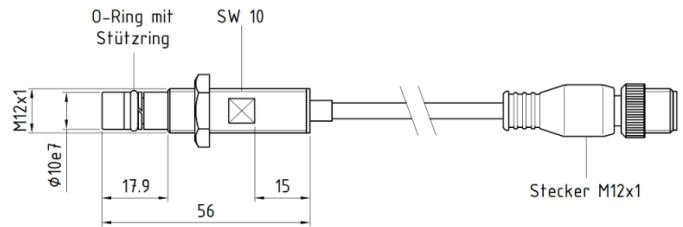
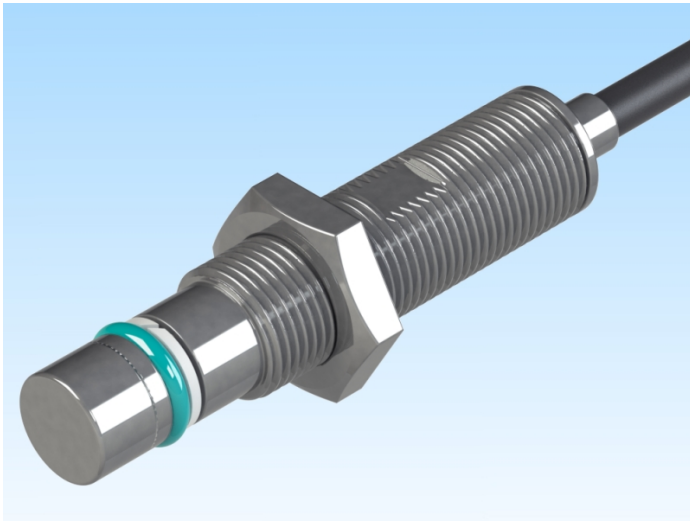

Name
Order number
Switching distance
Mounting

Switch type

Signal Type
Connection
Connection diagramm

KJD2-M12EB56-DPS-X0329/500/17,9
08310003812
2 mm

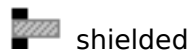

N.O.
DC PNP
connector M12

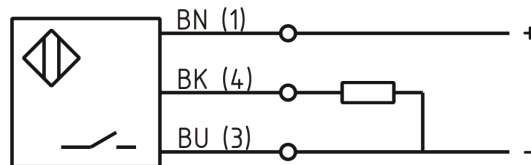

Dimension (in mm)
Technical Specification
Special features

fine-pitch thread M12 x 56

Operating voltage
Voltage drop
Max. load current
No load current
Leakage current
Switching frequency
Switching hysteresis
Operating temperature
Temperature drift
Repeat accuracy
Short-circuit proof
Overload protection
Reverse voltage protection
Protection category
EMC-level
Housing material
Cable length
Utilisation category
Cable material

pressure: 500 bar length pressure resistant area:
17,9 mm
10 - 30 V DC
2,4 V
200 mA
 ≤ 10 mA
 ≤ 10 μ A
400
 ≤ 15 %
-25 ° C to 100 ° C
 ≤ 10 %
 ≤ 5 %
yes
yes
yes
IP69K
DIN EN 60947-5-2: 2008
Stainless steel V2A
300 mm
DC 13
PUR LIFY11Y sw



KJD2-M12EB56-DPS-X0329/500/17,9

Pulsotronic GmbH & Co. KG Neue Schichtstraße 14b 09366 Niederdorf Deutschland +49 (0)37296 930-200

Cable cross

3x0.34 mm²

Errors and omissions exceptet