

[Article Page](#)

Product Description

ultrasonic sensor

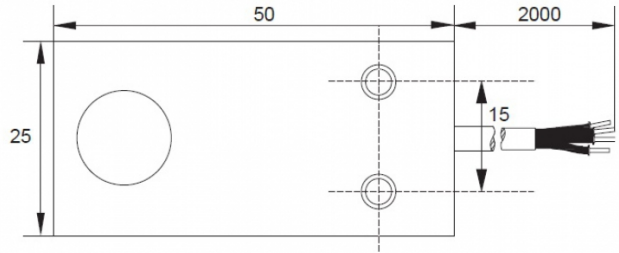

Name  
Order number  
Switch type

KUES1100-Q25KB-DPS  
08409862500

Signal Type  
Connection

 N.O.  
DC PNP

Connection diagramm

 Cable

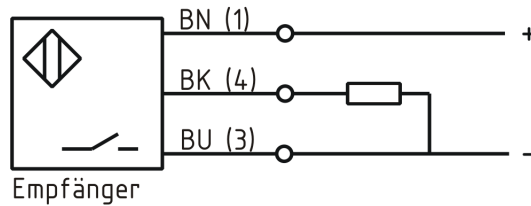
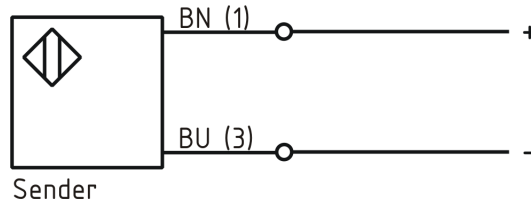

Dimension (in mm)  
Technical Specification

Q 25 x 12 x 50

Signal type  
Operating voltage  
Max. load current  
No load current  
Switching frequency  
Operating temperature  
Operating state  
Carrier frequency  
Sound beam  
Measuring range  
Short-circuit proof  
Overload protection  
Reverse voltage protection  
Protection category  
EMC-level  
Housing material  
Termination

Einwegschanke  
18 - 30 VDC  
500 mA  
≤ 40 mA  
150 Hz  
-15 ° C to 60 ° C  
LED  
180 kHz  
ca. 15°  
110 cm  
yes  
yes  
yes  
IP67  
DIN EN 60947-5-2:2008  
Plastic  
2m PVC 4x0,25mm<sup>2</sup>

**Errors and omissions exceptet**