

[Article Page](#)

Product Description

Touch Sensor

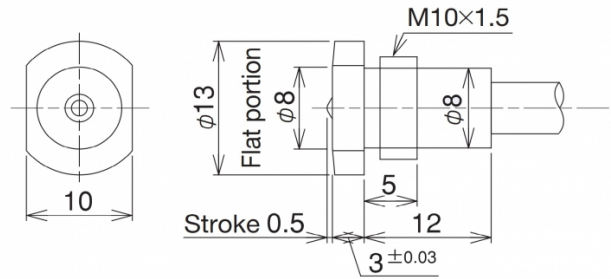

Name  
Order number  
Switch type

STM34A-L  
08430411008

Signal Type  
Connection  
Connection diagramm

 N.O.  
mechanical contact  
Cable 2m

Dimension (in mm)  
Technical Specification  
Operating voltage  
Max. load current  
Switching hysteresis  
Operating temperature  
Temperature drift  
Repeat accuracy

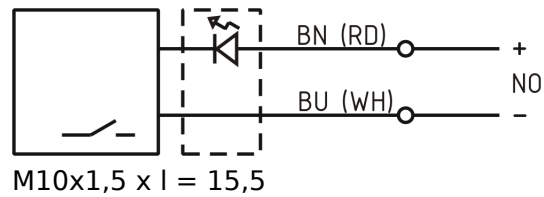

Switching state  
Stroke  
Pre-travel  
Accuracy  
Probe tip  
Probe tip material  
Static load  
Operation load  
art\_ttl\_mech  
Protection category  
Wiring  
Housing material  
Termination  
Approach direction

5 - 24 V DC  
10 mA  
0  
0 ° C to 80 ° C  
0  
0,01 mm (at operating speed 50 ... 200 mm/min)  
LED  
0,5 mm  
0,25 mm  
0,01 mm  
Kegel 3/R 0,75  
Edelstahl  
1500 N  
0,8 N  
10 Mio. operating cycles  
IP44  
Zweidraht/ Two wire  
Stainless steel V2A  
cable 2m, 2 wire, Ø2.8 mm, oil resistant  
axial

**Errors and omissions excepted**